

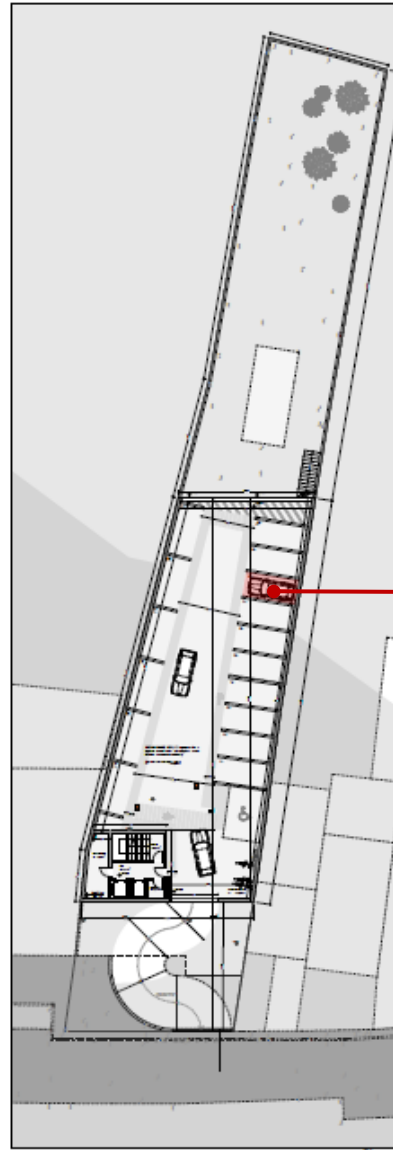

PLANTA

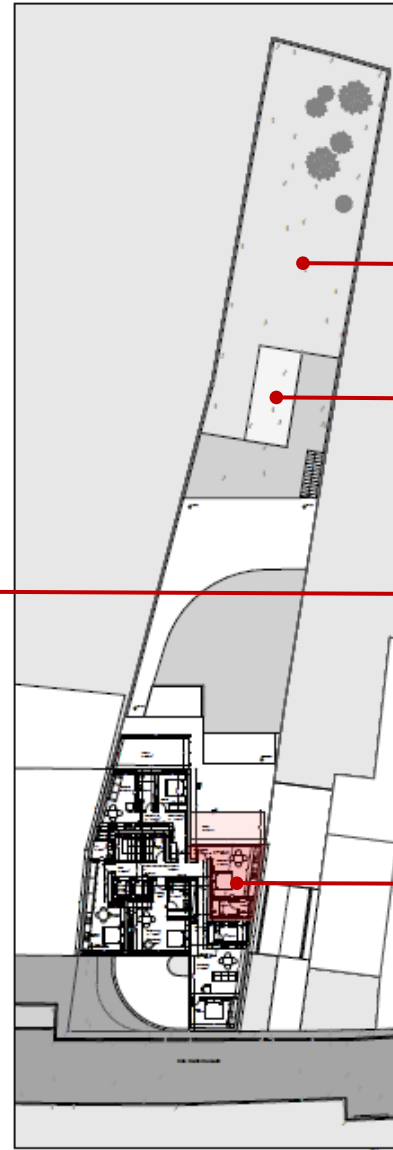

PISO -1



PISO 1

JARDIM

PISCINA

LUGAR DE GARAGEM

APARTAMENTO

08

FRAÇÃO

Rua Oliveira Gaió | Hospital S. João
Julho 2024 by BIG Arquitetos

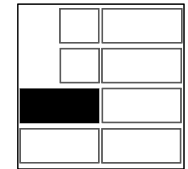

PISO 1

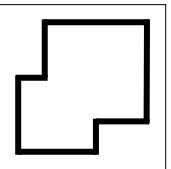

TIPOLOGIA - T0

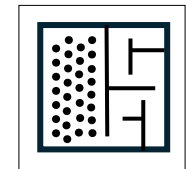

ÁREA = 37,08m²

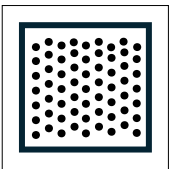

TERRAÇO = 20,85m²

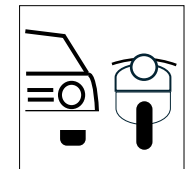

GARAGEM = 1

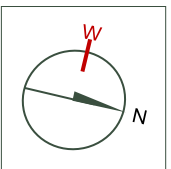

ORIENTAÇÃO

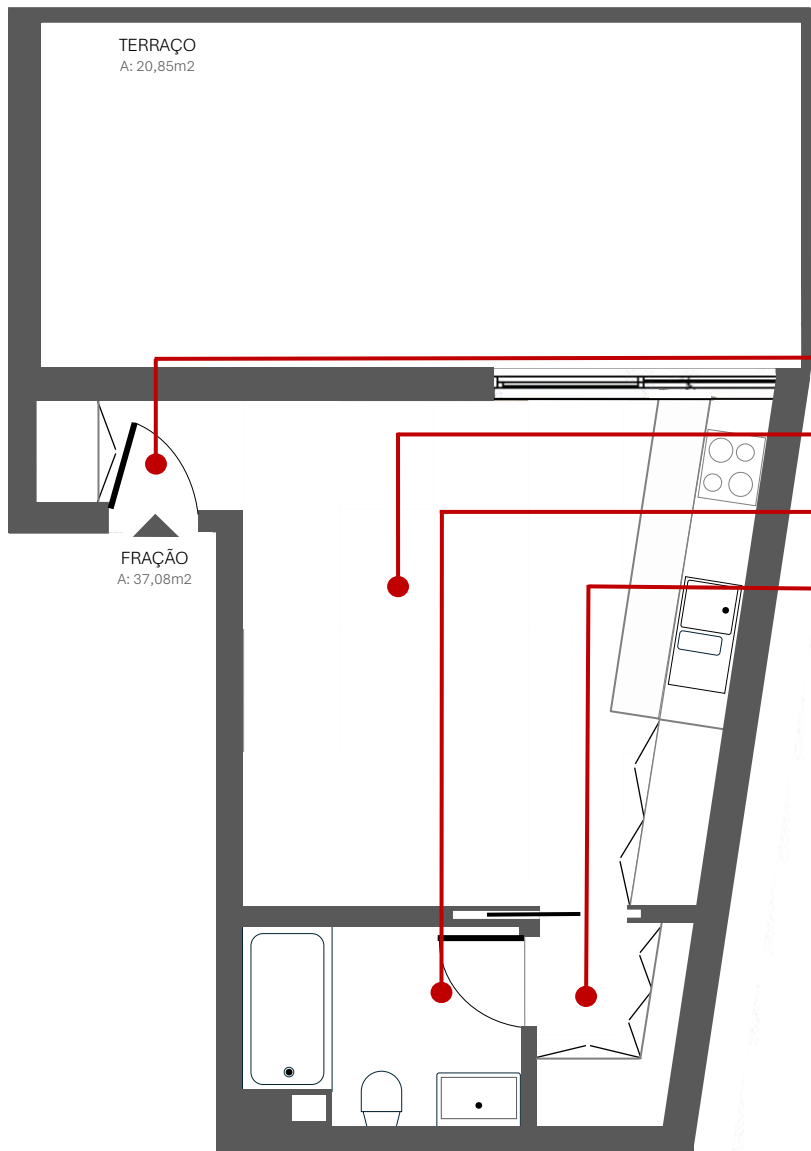

PLANTA

ÁREAS	PARCIAIS m2	TOTAIS m2
APARTAMENTO		37,08
HALL ENTRADA	02,18	
OPEN SPACE	21,35	
INSTALAÇÃO SANITÁRIA	04,50	
CLOSET	02,28	
TERRAÇO		20,85
ÁREA TOTAL DA FRAÇÃO		57,93
GARAGEM		13,50
ÁREA TOTAL		71,43



FRAÇÃO

Rua Oliveira Gaió | Hospital S. João
Julho 2024 by BIG Arquitetos

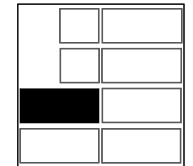

PISO 1

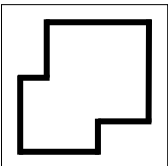

TIPOLOGIA - T0

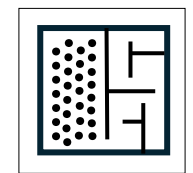

ÁREA = 37,08m2

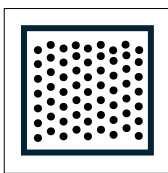

TERRAÇO = 20,85m2

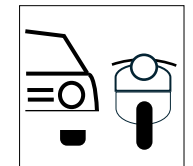

GARAGEM = 1

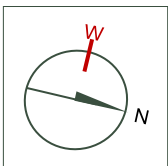

ORIENTAÇÃO

08

FRAÇÃO

Rua Oliveira Gaió | Hospital S. João
Julho 2024 by BIG Arquitetos

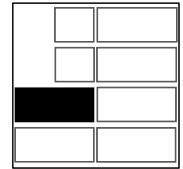
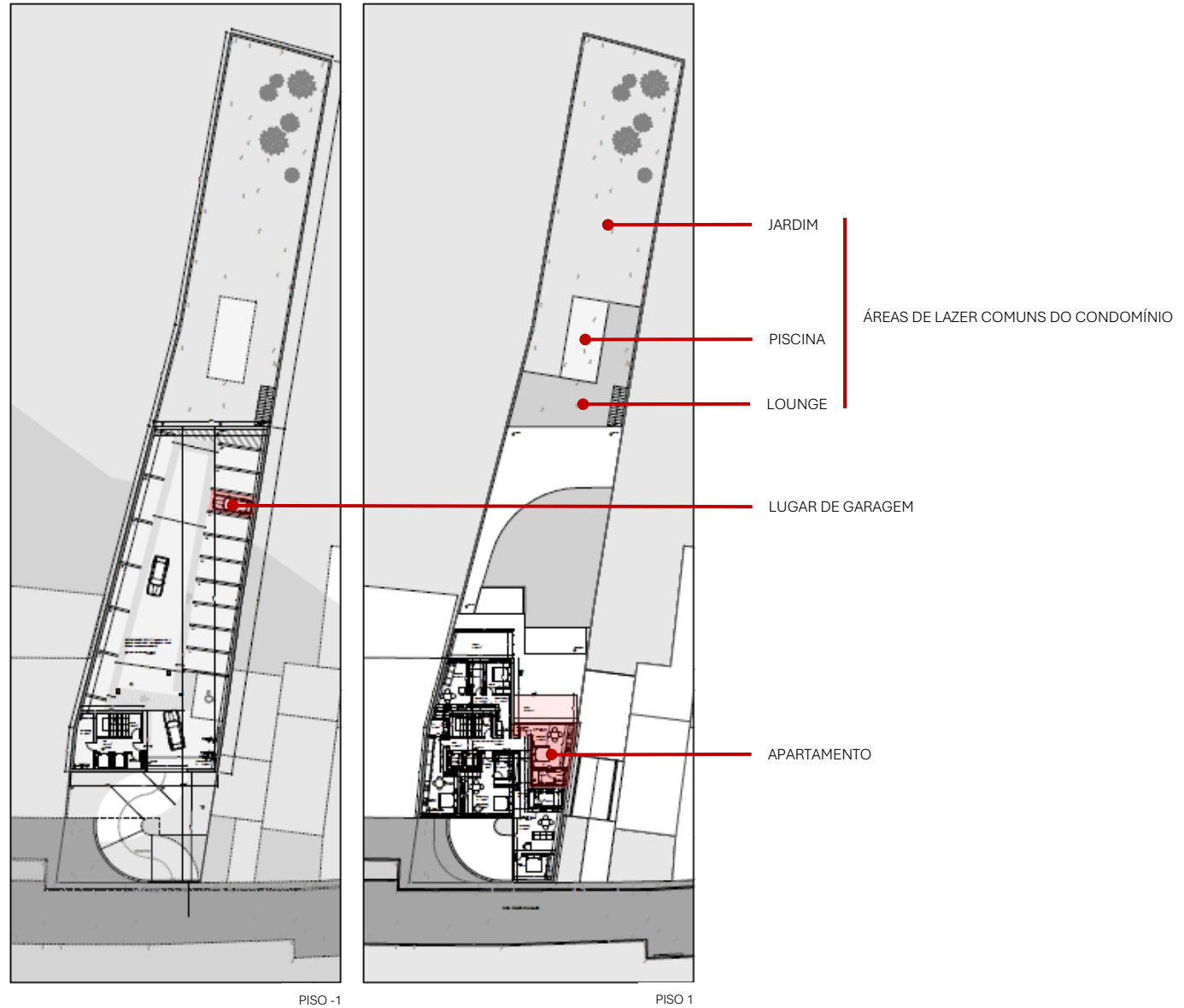

PISO 1

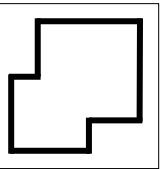

TIPOLOGIA - T0

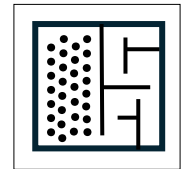

ÁREA = 37,08m²

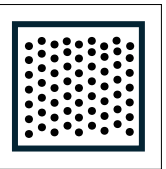

TERRAÇO = 20,85m²

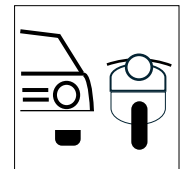

GARAGEM = 1

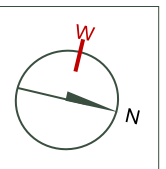

ORIENTAÇÃO