

3 Bedroom Apartment
Ground floor
APT. V1-603

Phase 01

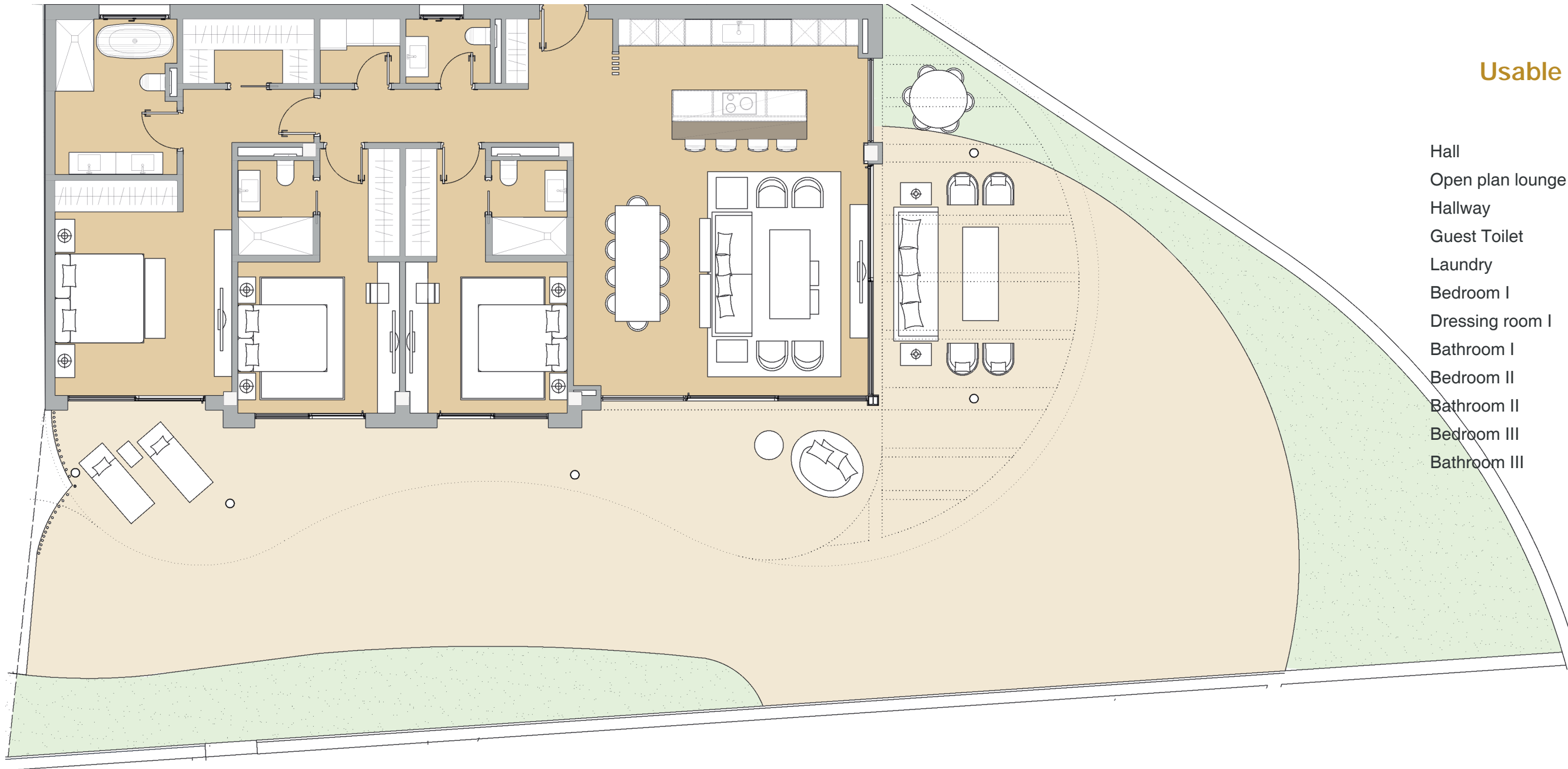

Usable area

Hall	6,01 m ²
Open plan lounge	53,03 m ²
Hallway	5,62 m ²
Guest Toilet	2,76 m ²
Laundry	2,61 m ²
Bedroom I	23,58 m ²
Dressing room I	4,27 m ²
Bathroom I	9,34 m ²
Bedroom II	16,86 m ²
Bathroom II	3,59 m ²
Bedroom III	16,86 m ²
Bathroom III	3,59 m ²

Property Orientation

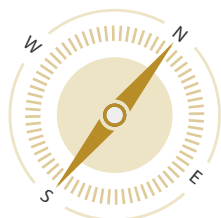

Site Plan

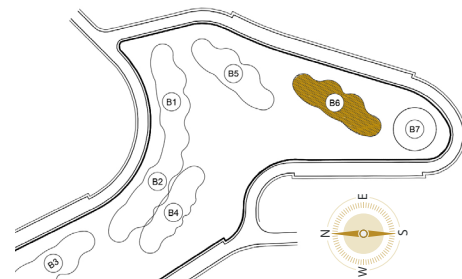

Block 06

V1-611 3 BEDS	V1-612 2 BEDS	V1-613 3 BEDS
V1-601 3 BEDS	V1-602 2 BEDS	V1-603 3 BEDS

Apartment | V1-603

Indoor constructed area: 174,41 m² / Indoor usable area: 148,12 m²
Terrace area: 210,71 m²
Private garden*: 69,32 m²
Total area: 453,83 m²

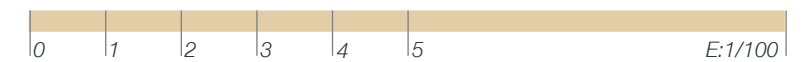

This document is for information only. The areas and measurements shown are approximate and may be modified for technical reasons and/or administrative issues. All furniture shown is for illustrative purposes. *Communal area with private use for the property.