





This document is for information only. The areas and measurements are approximate and may be modified for technical reasons and/or administrative issues. The room areas marked on the drawing are usable space.

Villa 6

Built closed area	411,84 m ²
Covered terrace	38,70 m ²
Open terrace	110,11 m ²
Total terrace	148,81 m ²
Pool	55,12 m ²

Total built area 615,77 m²

 5
  4
  411,84 m²
 4



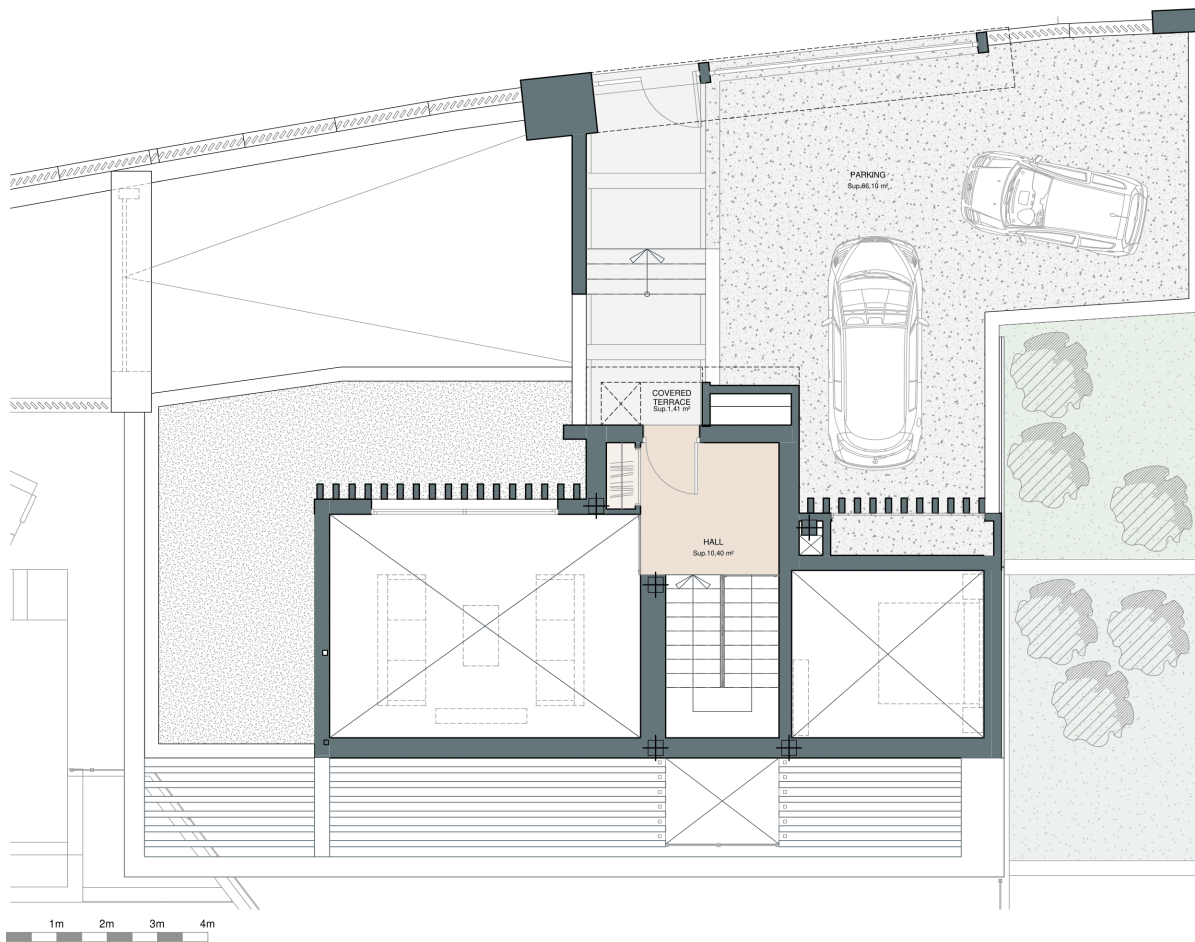





This document is for information only. The areas and measurements are approximate and may be modified for technical reasons and/or administrative issues. The room areas marked on the drawing are usable space.

Villa 6

Built closed area	411,84 m ²
Covered terrace	38,70 m ²
Open terrace	110,11 m ²
Total terrace	148,81 m ²
Pool	55,12 m ²

Total built area 615,77 m²

 5
  4
  411,84 m²
 4

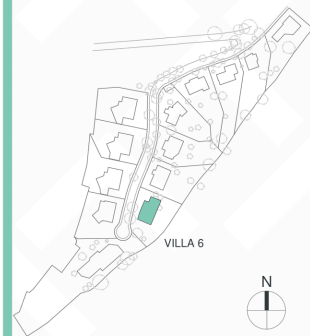

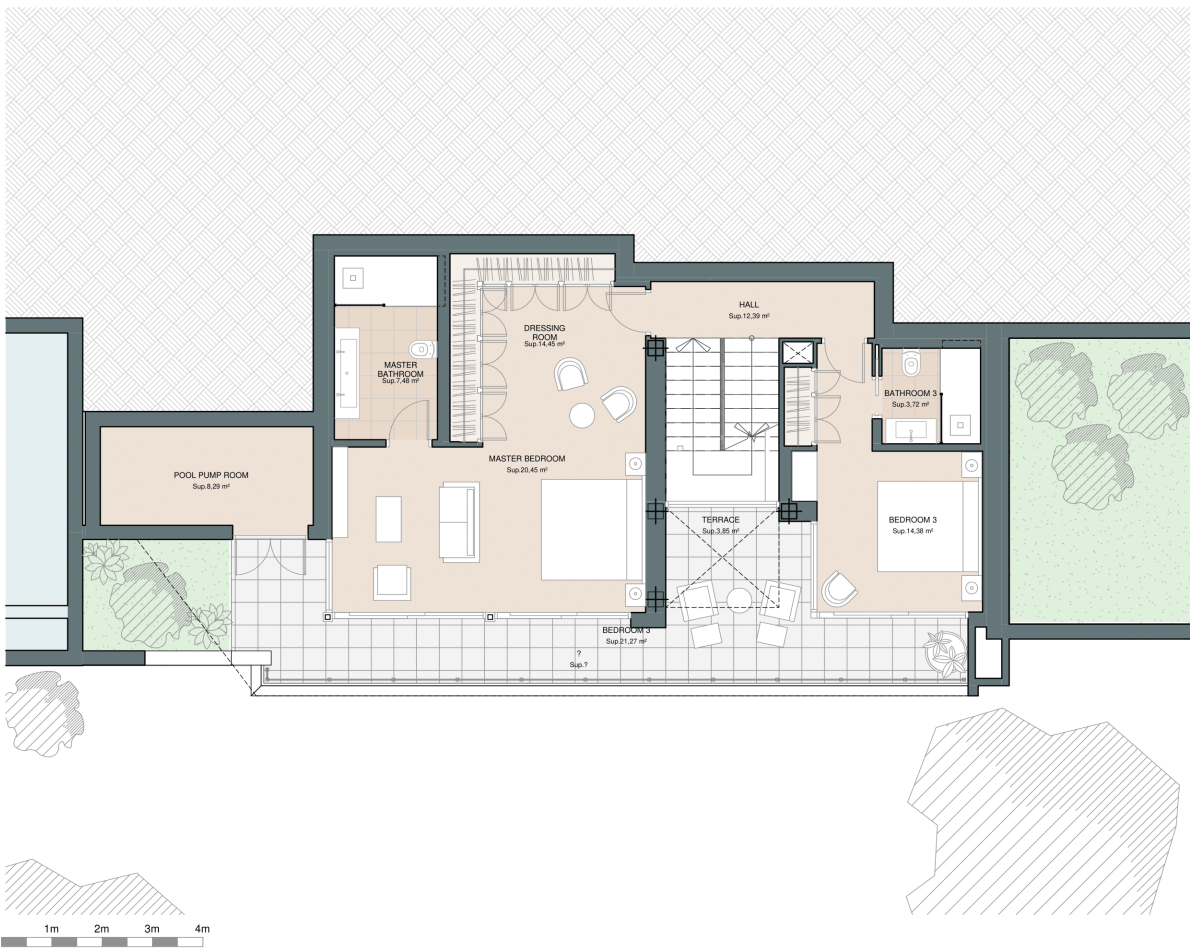





Villa 6

Built closed area	411,84 m ²
Covered terrace	38,70 m ²
Open terrace	110,11 m ²
Total terrace	148,81 m ²
Pool	55,12 m ²

Total built area 615,77 m²

 5
  4
  411,84 m²
 4





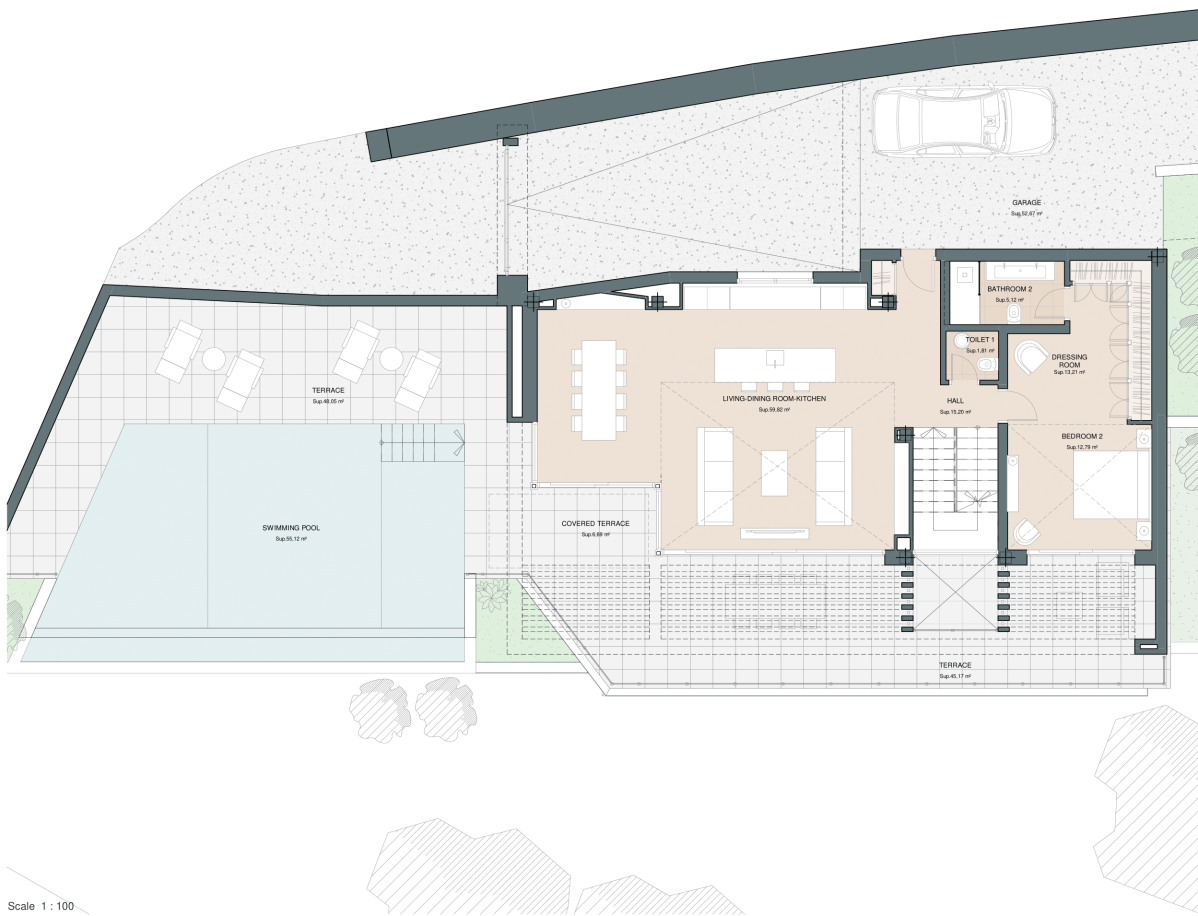

This document is for information only. The areas and measurements are approximate and may be modified for technical reasons and/or administrative issues. The room areas marked on the drawing are usable space.



Villa 6

Built closed area	411,84 m ²
Covered terrace	38,70 m ²
Open terrace	110,11 m ²
Total terrace	148,81 m ²
Pool	55,12 m ²

Total built area 615,77 m²

 5
  4
  411,84 m²
 4

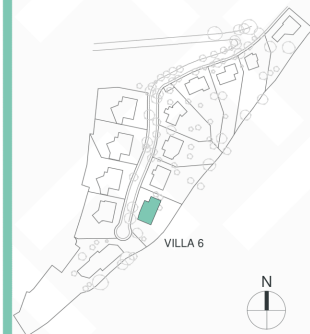

Scale 1 : 100
1m 2m 3m 4m 5m

This document is for information only. The areas and measurements are approximate and may be modified for technical reasons and/or administrative issues. The room areas marked on the drawing are usable space.