

# SUNRISE BAY

RESIDENCES

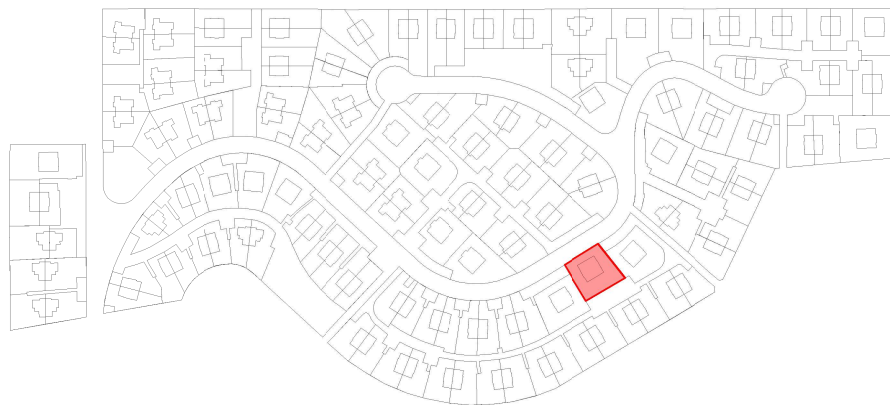

## HOUSE MIII-11/12-E+ (ground floor)



Useful area

Living-dining	51,60 m <sup>2</sup>
Kitchen	8,56 m <sup>2</sup>
Bathroom 1	2,54 m <sup>2</sup>
Office	6,80 m <sup>2</sup>
Bedroom 1	8,64 m <sup>2</sup>
Bathroom 2	2,54 m <sup>2</sup>
Laundryroom	2,25 m <sup>2</sup>
Storage space	2,25 m <sup>2</sup>
Staircase	10,88 m <sup>2</sup>
Bedroom 2	10,42 m <sup>2</sup>
Bathroom 2	4,05 m <sup>2</sup>
Bedroom 3	10,42 m <sup>2</sup>
Bathroom 3	4,05 m <sup>2</sup>

Total useful interior area 125,00 m<sup>2</sup>

Built area

Closed built area	150,00 m <sup>2</sup>
Terrace built area	88,61 m <sup>2</sup>
Total built area	238,61 m <sup>2</sup>

Garden area 322,73 m<sup>2</sup>

Plot area 508,34 m<sup>2</sup>

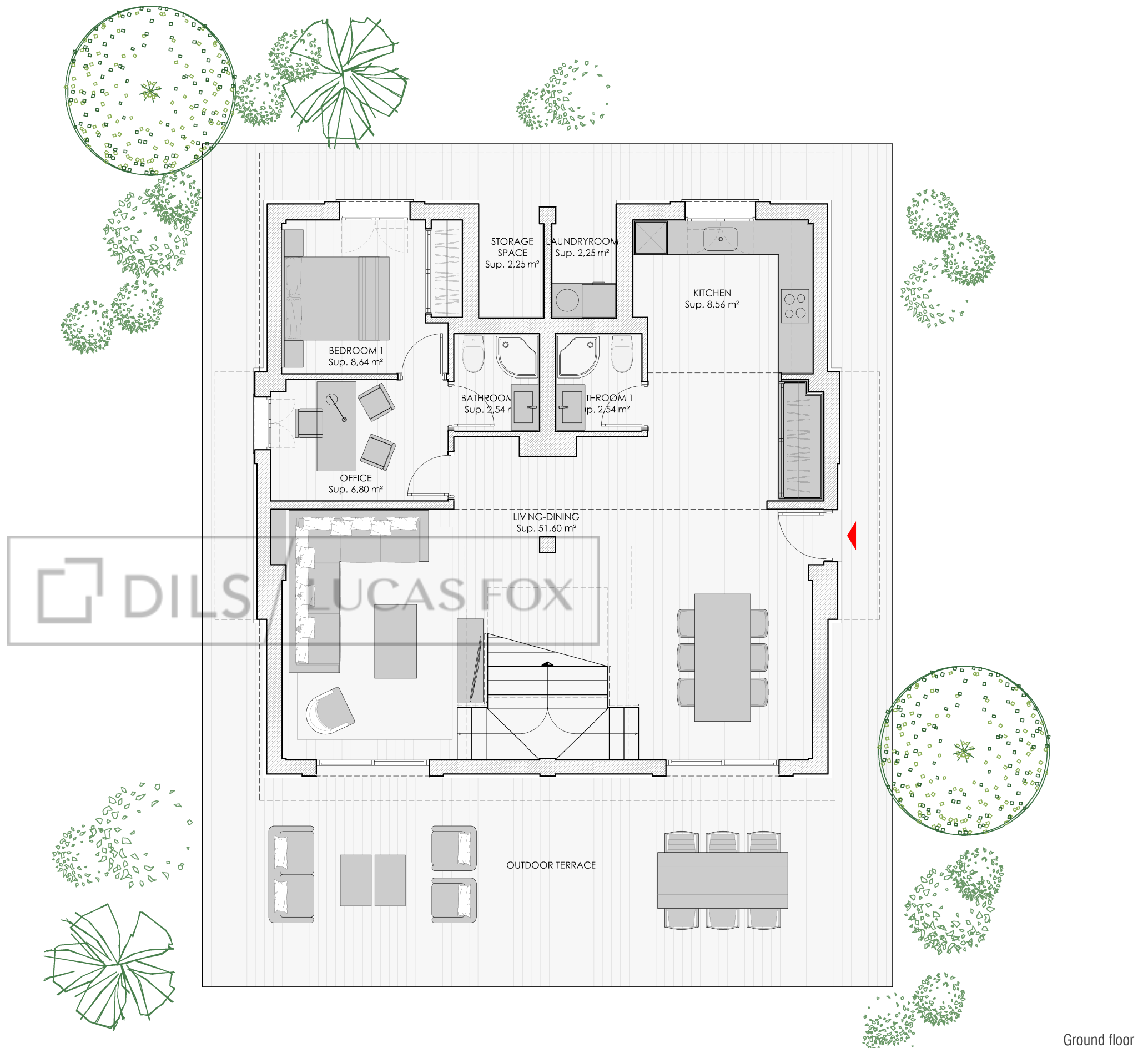

Ground floor

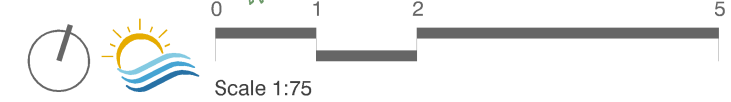

Representative plan of the project is not a contractual document; It may be subject to changes due to technical, legal or administrative requirements and licenses, as well as the construction or design necessities derived from the project development and works/construction management. All decorative and furniture elements are merely indicative.

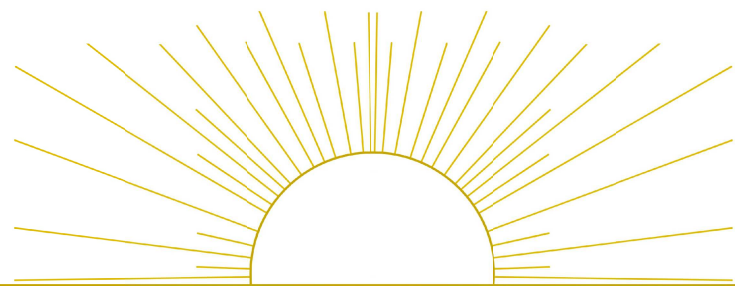

# SUNRISE BAY

RESIDENCES

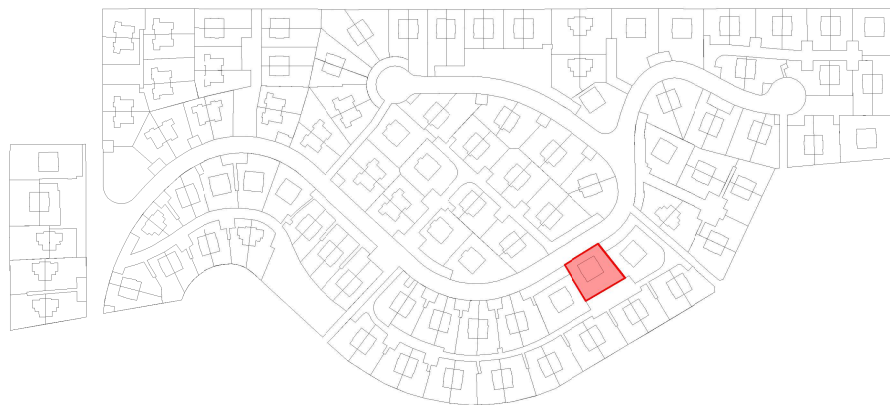

## HOUSE MIII-11/12-E+ (first floor)



### Useful area

Living-dining	51,60 m <sup>2</sup>
Kitchen	8,56 m <sup>2</sup>
Bathroom 1	2,54 m <sup>2</sup>
Office	6,80 m <sup>2</sup>
Bedroom 1	8,64 m <sup>2</sup>
Bathroom 2	2,54 m <sup>2</sup>
Laundryroom	2,25 m <sup>2</sup>
Storage space	2,25 m <sup>2</sup>
Staircase	10,88 m <sup>2</sup>
Bedroom 2	10,42 m <sup>2</sup>
Bathroom 2	4,05 m <sup>2</sup>
Bedroom 3	10,42 m <sup>2</sup>
Bathroom 3	4,05 m <sup>2</sup>

Total useful interior area 125,00 m<sup>2</sup>

### Built area

Closed built area	150,00 m <sup>2</sup>
Terrace built area	88,61 m <sup>2</sup>
Total built area	238,61 m <sup>2</sup>

Garden area 322,73 m<sup>2</sup>

Plot area 508,34 m<sup>2</sup>

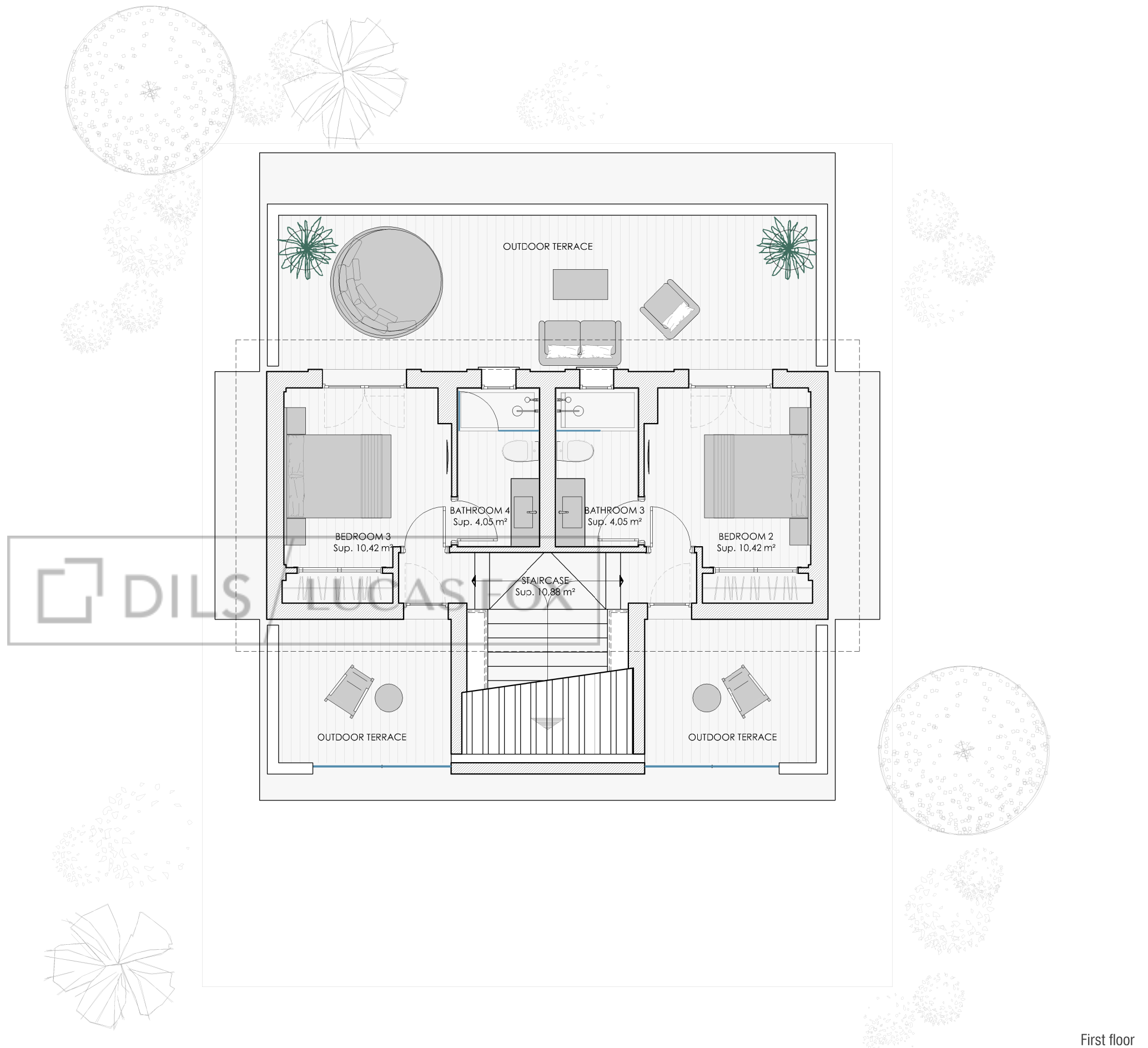

First floor

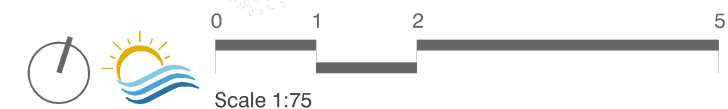

Representative plan of the project is not a contractual document; It may be subject to changes due to technical, legal or administrative requirements and licenses, as well as the construction or design necessities derived from the project development and works/construction management. All decorative and furniture elements are merely indicative.