

### SUPERFICIES ÚTILES (m<sup>2</sup>)

|                       |                  |       |   |              |        |
|-----------------------|------------------|-------|---|--------------|--------|
| 1                     | Cocina / Office  | 12.32 | 5 | Baño 1       | 4.20   |
| 2                     | Salón / Comedor  | 24.30 | 6 | Baño 2       | 3.40   |
| 3                     | Habitación suite | 10.86 | 7 | Distribuidor | 9.70   |
| 4                     | Habitación 2     | 11.86 | 8 | Lavadero     | 2.59   |
|                       |                  |       | 9 | Terraza      | 15.05  |
| SUPERFICIE ÚTIL TOTAL |                  |       |   |              | 94.25  |
| SUPERFICIE CONSTRUIDA |                  |       |   |              | 127.78 |

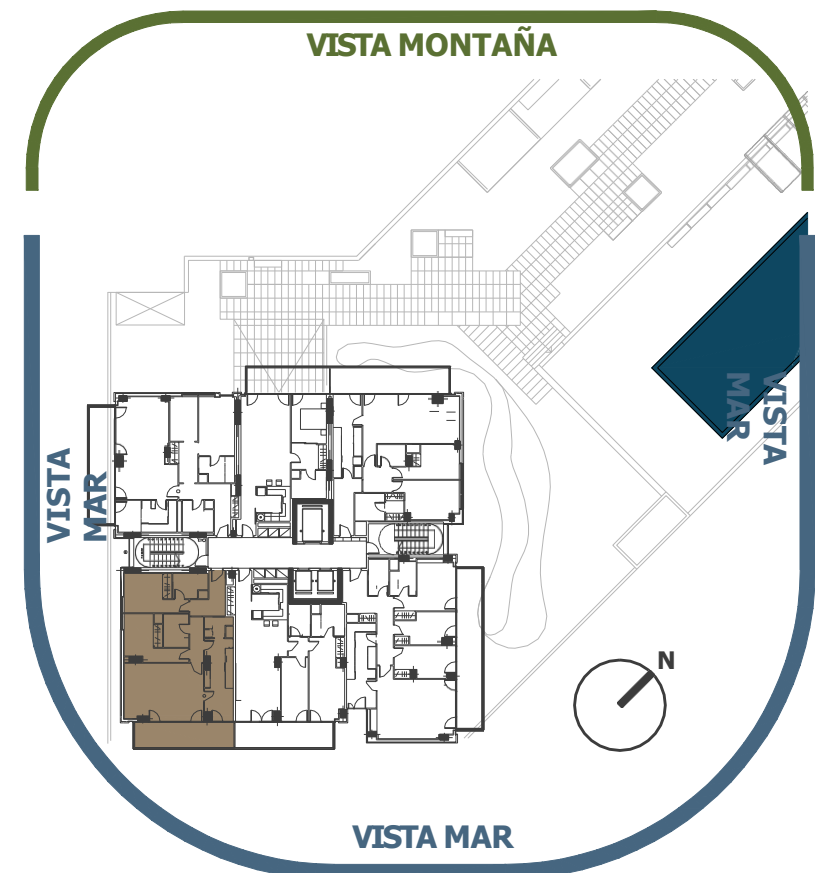

## TORRE A - Planta 1 a 16 puerta 3<sup>a</sup>