

Measurements FIRST FLOOR	
INTERIOR (Useful surface)	229.85m²
Balcony	22.60m²
Built surface	258.20m²
Height	2.70m
TOTAL	
INTERIOR (Useful surface)	335.75m²
Exterior surface	57.60m²
Built surface	376.00m²

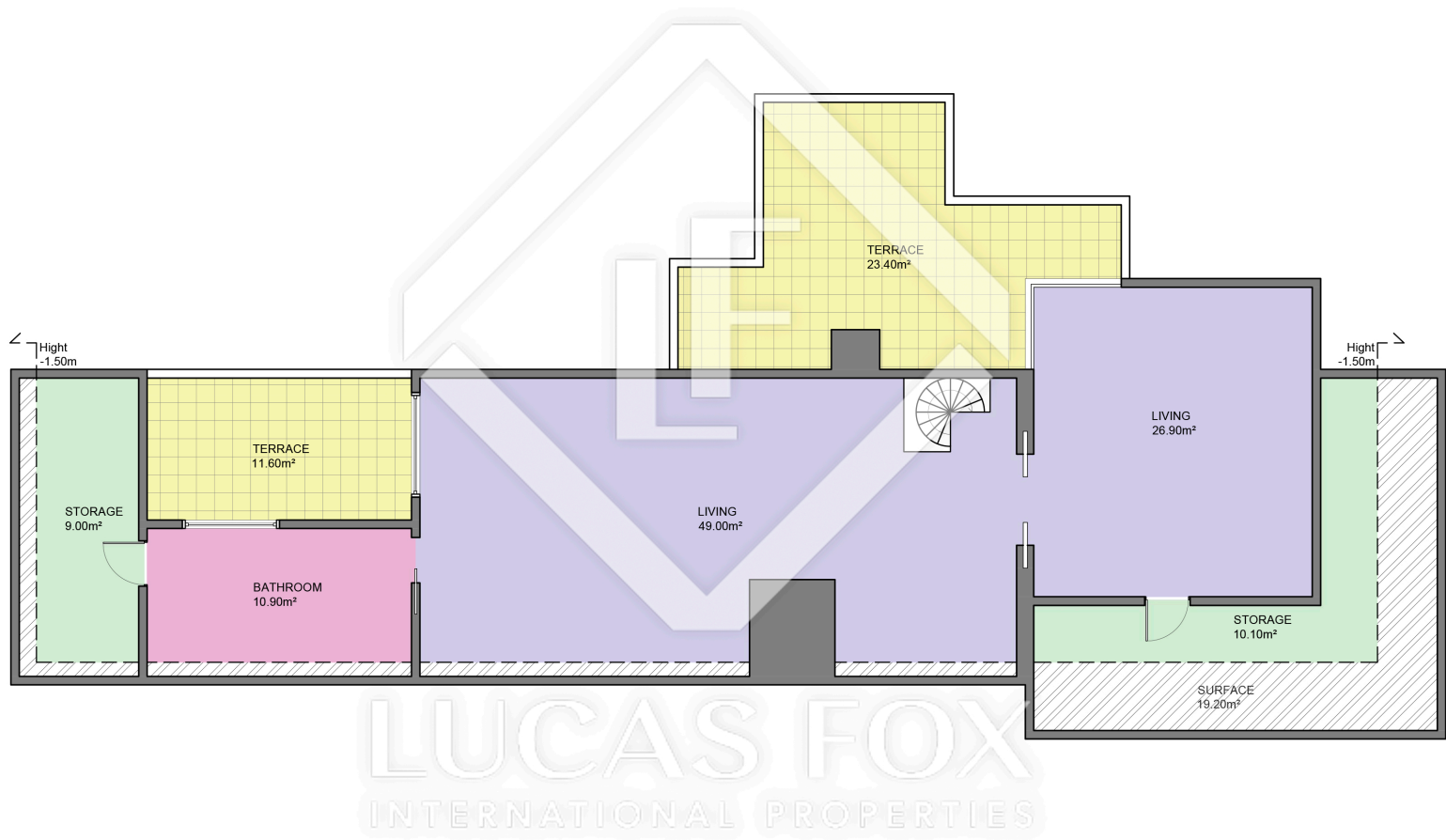
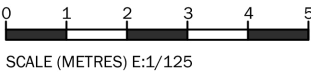

Measurements ATTIC FLOOR	
INTERIOR (Useful surface)	105.90m²
Terrace	35.00m²
Built surface	117.80m²
<hr/>	
TOTAL	
INTERIOR (Useful surface)	331.75m²
Exterior surface	57.60m²
Built surface	376.00m²