

HAPPINESS AWAITS YOU 6

Location – Feel the embrace of the Mediterranean 8

Lifestyle – Your wellbeing, life’s greatest treasure 18

The project

WHERE AVANT-GARDE AND COMFORT MEET 22

Homes

SPACES THAT ADAPT TO YOU 26

Commercial Plans

DISCOVER YOUR HOME 28

Specifications

A PERFECT COMPOSITION 38

Santa Eulàlia apartments

HAPPINESS AWAITS YOU

Offers you a unique opportunity to own the home of your dreams in **Santa Eulària des Riu**, one of the most charming towns in Ibiza. Painted white, surrounded by wild nature and bathed by turquoise Mediterranean waters, it stands as an idyllic setting that's hard to match.

A new development project comprising **38 homes with 2 and 3 bedrooms**, featuring a **magnificent swimming pool**, as well as **parking spaces and storage rooms**. Undoubtedly, it is an excellent option both for investors and for those looking to start a new life on the White Island, or seeking a second residence.



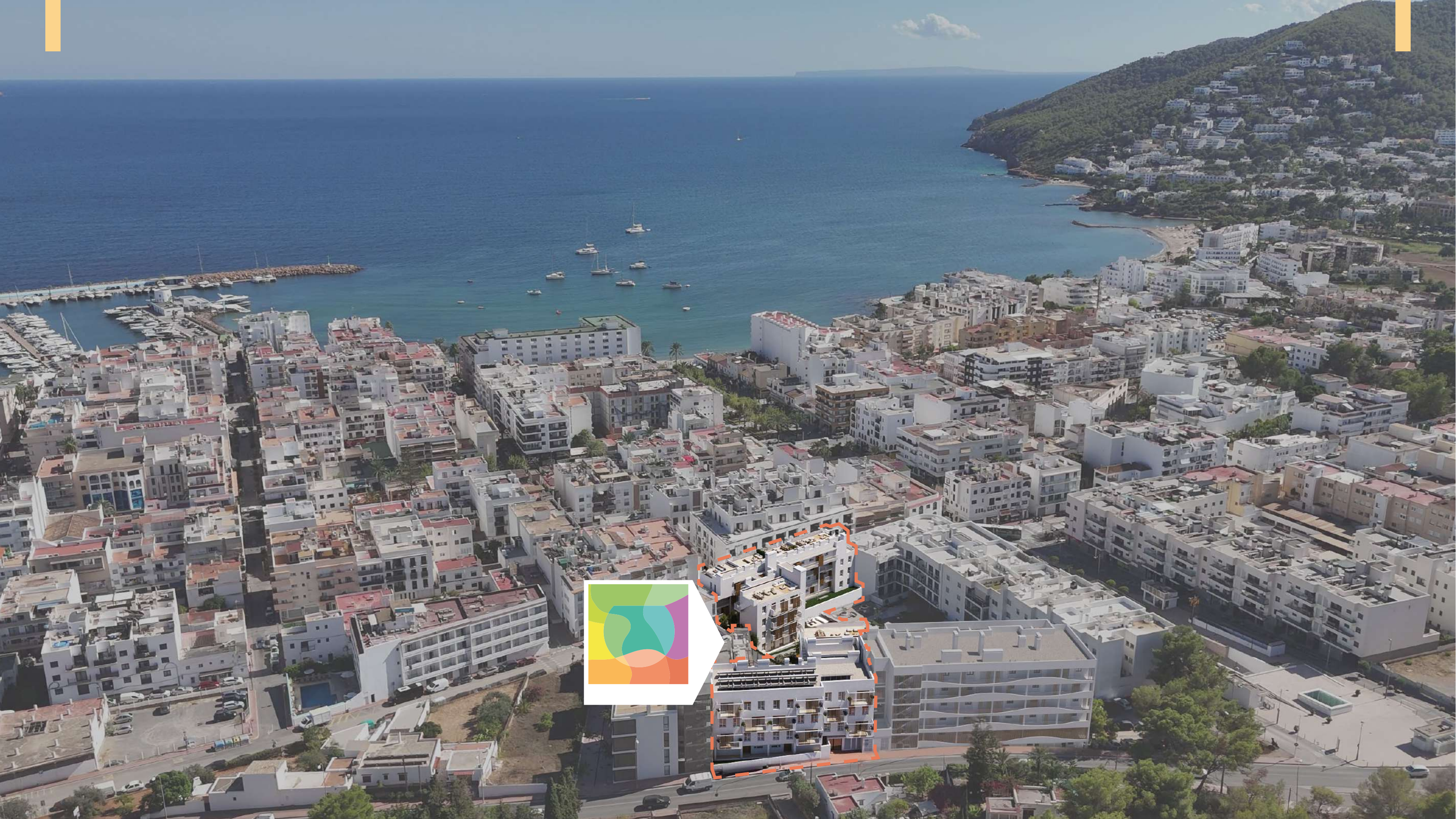

FEEL THE EMBRACE OF THE MEDITERRANEAN

Location

Located on Carrer de Camí de Missa, lies in a **quiet yet well-connected area**, allowing you to combine the serenity of a natural environment with proximity to the sea and to all main amenities in Santa Eulària des Riu.

This beautiful Ibizan town is known for its family-friendly atmosphere, stunning beaches, marina and its rich cultural and gastronomic offerings. **It is located 22 km from the island's airport and 15 km from Ibiza's port**, the two main gateways to the island used by commercial transport companies.

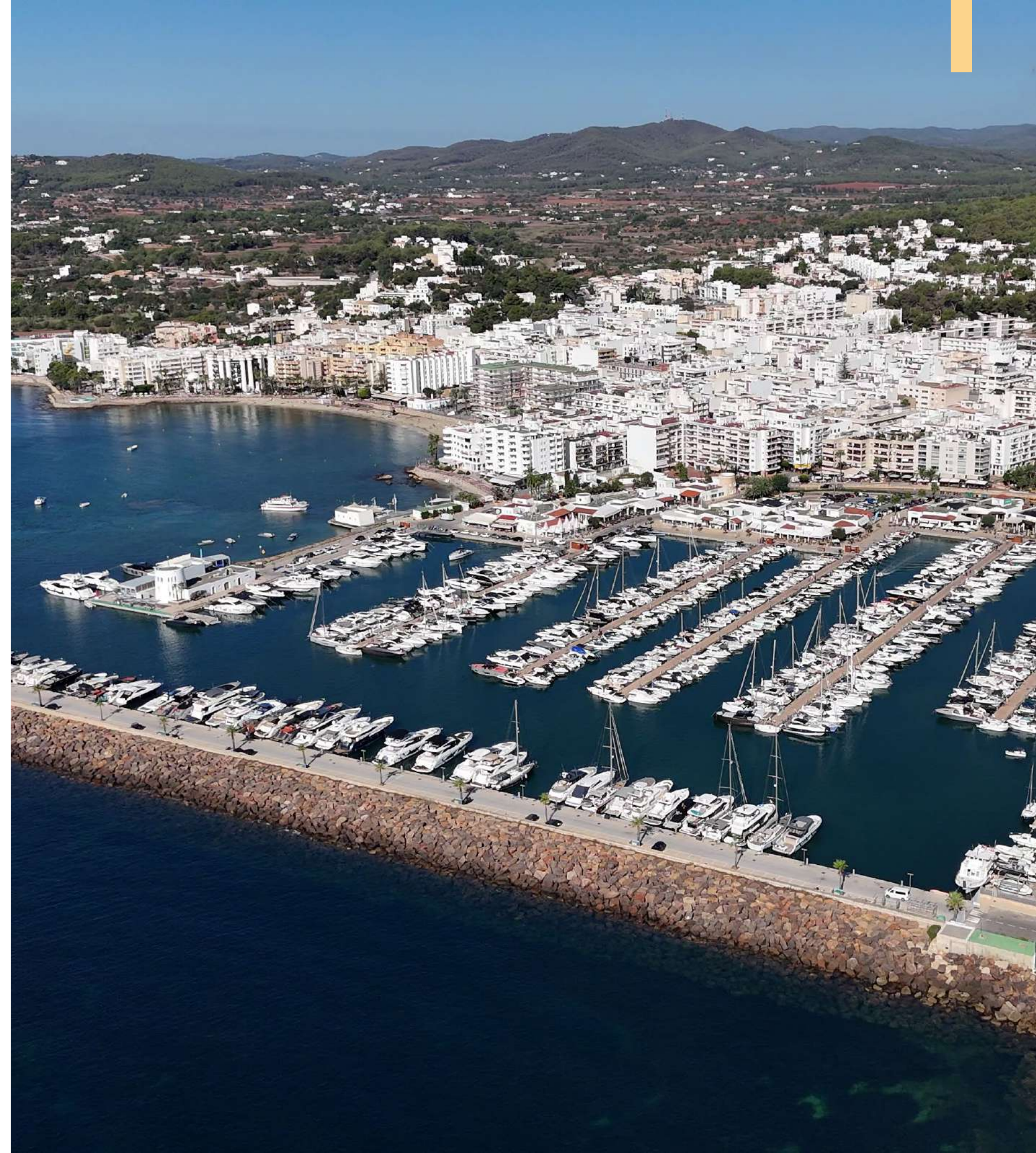

The strong housing demand, driven by the island's tourist appeal and high quality of life, makes every project developed in this area not only a **privileged place to live**, but also an **investment with high potential** for medium- and long-term appreciation.



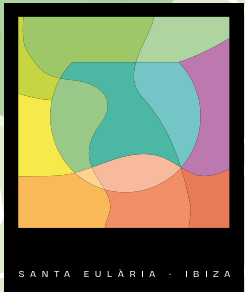

SANTA EULÀRIA - IBIZA

EDUCATION

- 11. CP Santa Eulària School
- 12. CEIP Sant Ciriac
- 13. Valdelors School
- 14. IES Xarc

PARKS

- 15. Can Fluixà Park
- 16. Passeig de s'Alamera
- 17. Sa Plaça des Canó Children's Park

HEALTH

- 18. Santa Eulària Health Centre

LEISURE

- 19. Olas Gallery
- 20. Teatro España

BRIDGES

- 5. Santa Eulària River Bridge
- 6. Pont Vell

CULTURE

- 7. Santa Eulària River Interpretation Centre
- 8. Ethnographic Museum of Ibiza
- 9. Des Molí d'Enmig Tower
- 10. Ibiza Conference Palace

PORT

- 1. Santa Eulària Ferry
- 2. Marina Santa Eulària

BEACH

- 3. Santa Eulària Beach
- 4. Babylon Beach

YOUR WELLBEING, LIFE'S GREATEST TREASURE

Lifestyle

Everyday life in Santa Eulària des Riu moves at a different pace. Let yourself be carried away by the calm that fills every corner and unwind to the gentle sigh of the Mediterranean breeze.

Located on the eastern side of the White Island, this town embodies a tranquil yet sophisticated lifestyle, ideal for those seeking a balance between nature, culture, and activity. One of **its main attractions is its marina, the location of which allows easy access to the island's many coves, perfect for sailing through crystal-clear waters.** Many consider it the ideal home port for exploring the southeast coast, a favourite area among those looking for less crowded spots.

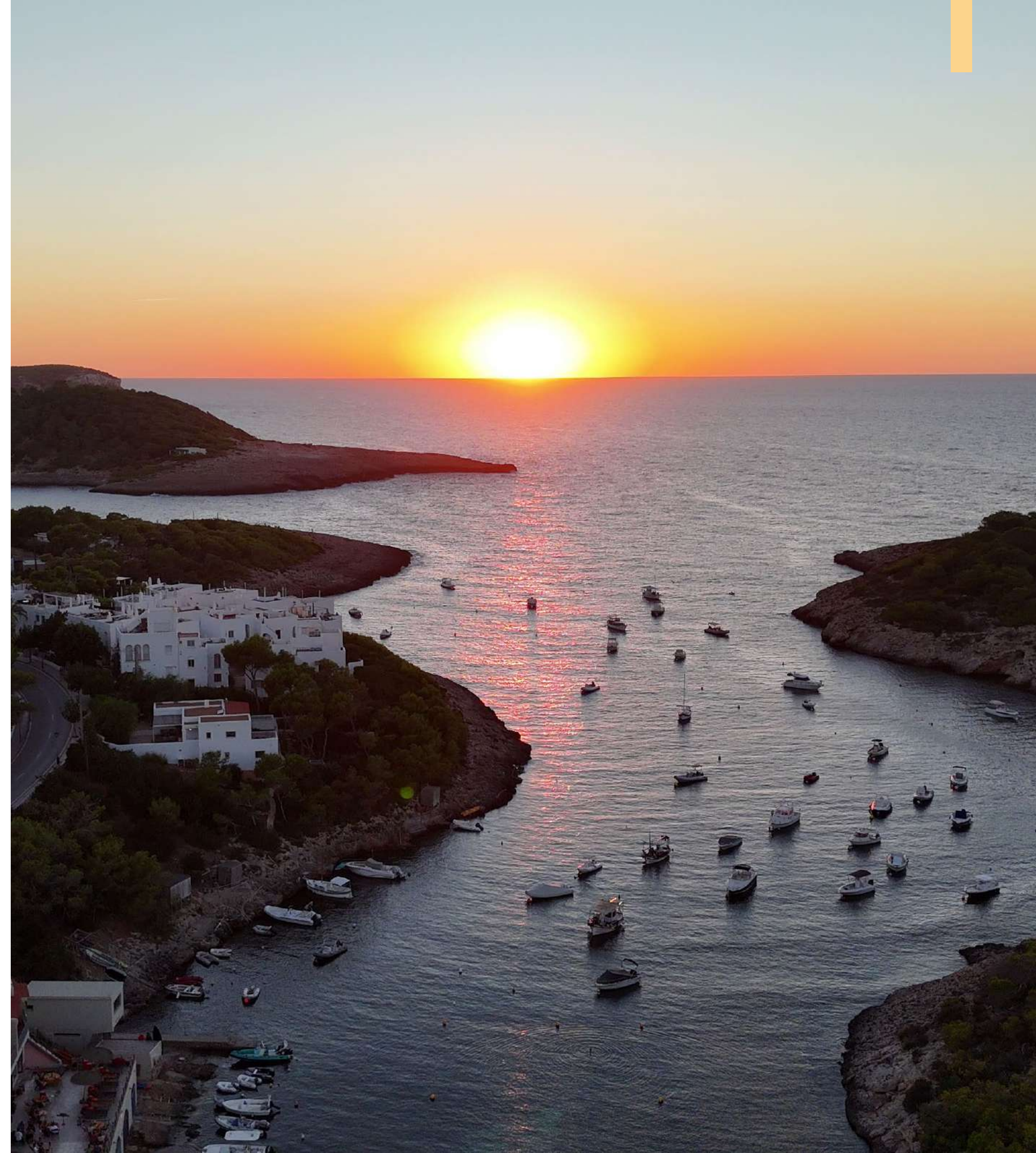



The streets of Santa Eulària are filled with cafés, independent boutiques, and seaside restaurants offering Mediterranean and healthy cuisine.

Its **crystal-clear beaches** are perfect for paddleboarding, kayaking or simply soaking up the sun. The surrounding area also offers hiking and cycling routes that wind through rural landscapes and almond fields. The presence of the only river in the Balearic Islands, the Santa Eulària River, adds further ecological value to the area and strengthens the bond between **urban life and nature**.

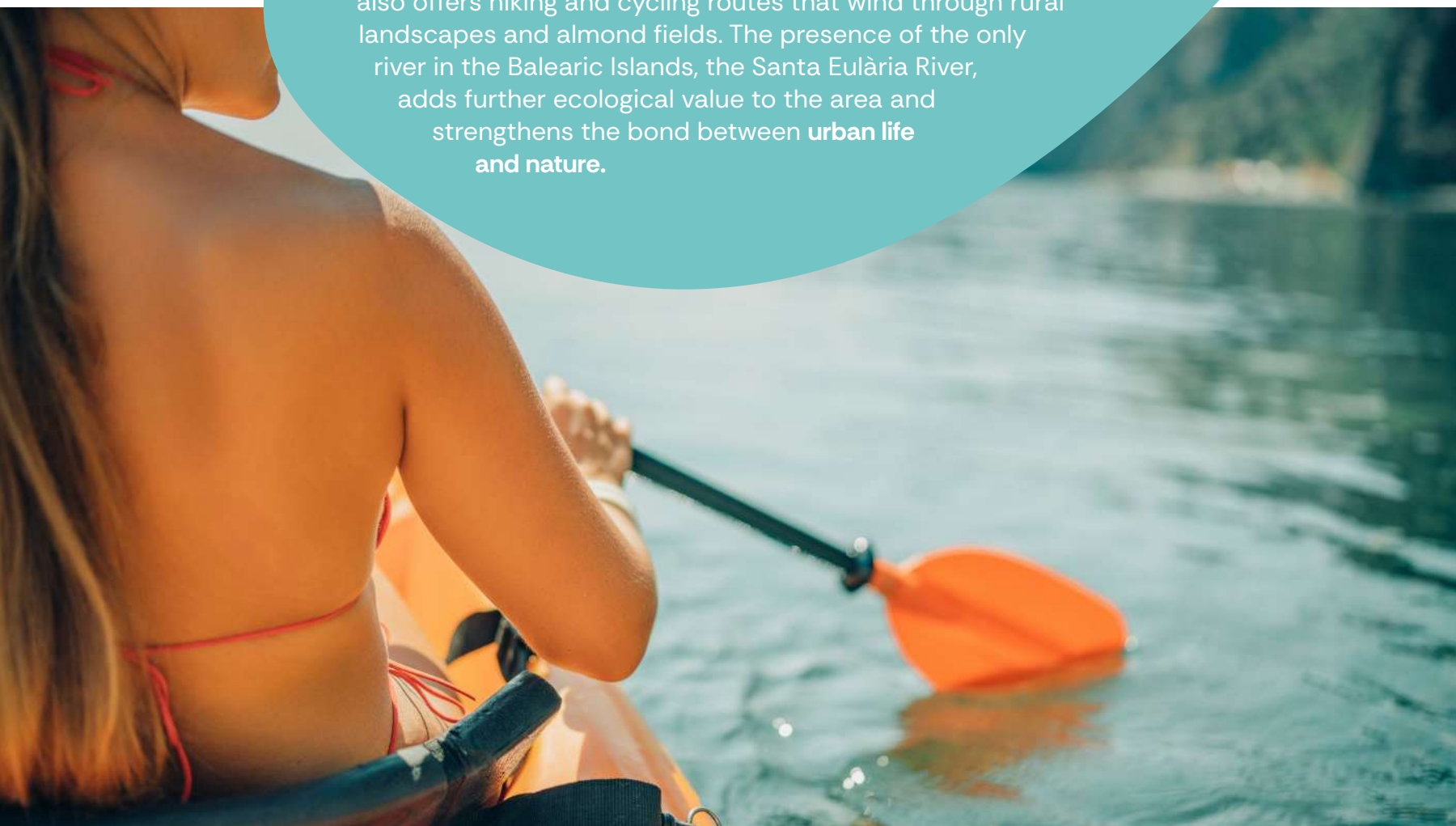

The project

WHERE AVANT-GARDE
AND COMFORT MEET

A **modern new-build development** composed of **two residential buildings** that share a **magnificent swimming pool** and are surrounded by lush gardens, creating a direct connection with nature.

In total, there are **38 homes with two and three bedrooms**. The project stands out for its contemporary design and diverse layouts, allowing you to choose from different types that suit various lifestyles.

Among them are **extraordinary penthouses with large solarium terraces** offering the best views.

Both buildings are connected via an **underground garage**. The basement level houses storage rooms, providing the perfect solution for extra space and allowing you to enjoy more room in your home for everyday living.

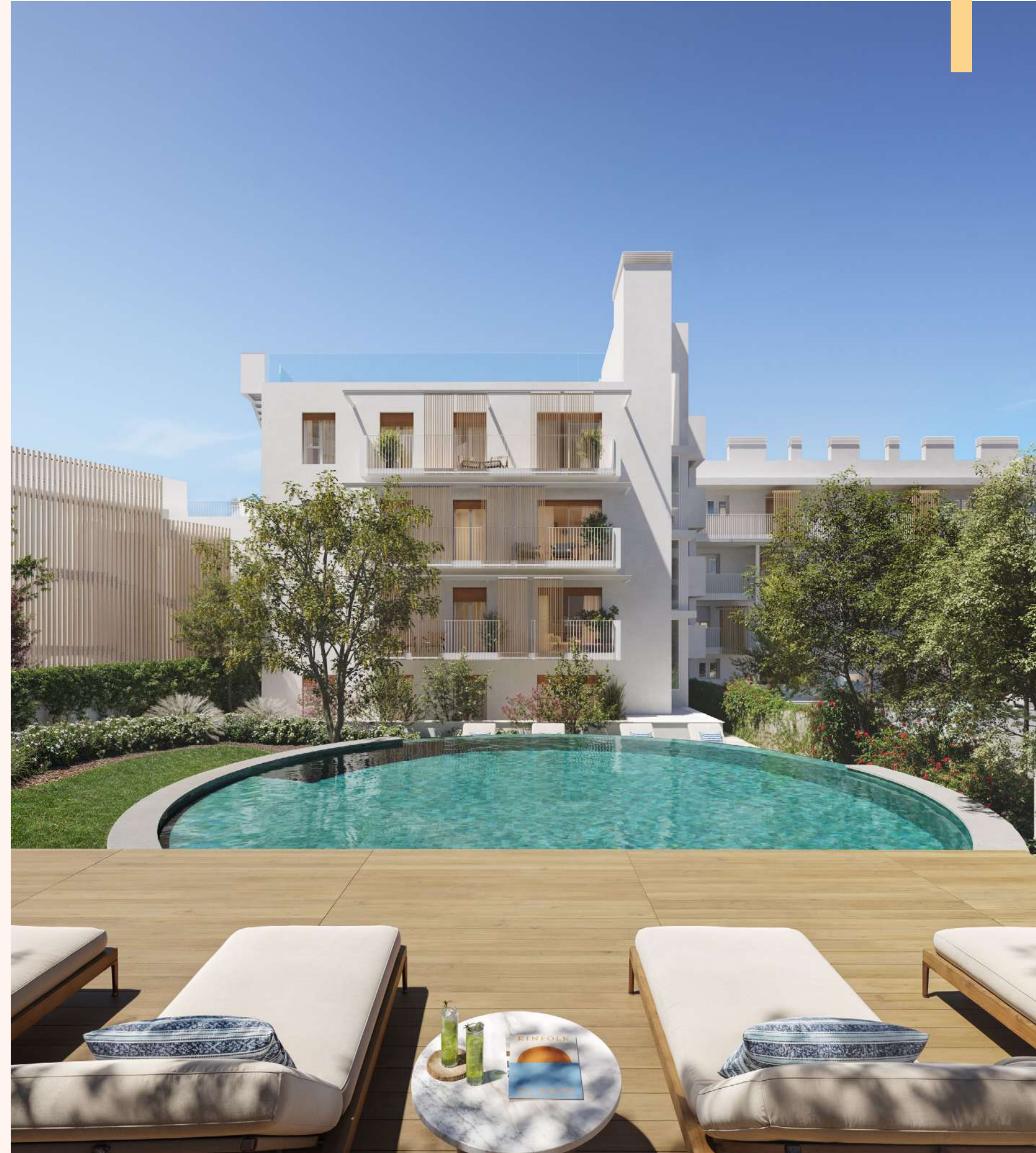





Homes

SPACES THAT
ADAPT TO YOU

Each of the residences has been built with **high-quality finishes**. The design **prioritises natural light and energy efficiency**, and most units feature a terrace or solarium with spectacular views of the surroundings.

Its characteristics make it the perfect home both for year-round living and for enjoying holiday periods in total comfort. Offers you a **Mediterranean lifestyle, modern design and closeness to nature**. A perfect combination that lives up to your highest expectations.











Enjoy the privilege of daydreaming







Feel the embrace of the Mediterranean