

General Plan

Common Areas

Common Areas › m²

Swimming Pool › 77,65 m²

Garden › 67,60 m²

Paved Area › 667,80 m²

Changing Room › 4,35 m²

Chemical Store › 2,25 m²

Installations › 1,80 m²

Total Areas › m²

Common Areas › 794,40 m²

Basement 1 › 814,30 m²

Basement 2 › 834,00 m²

Basement 3 › 760,30 m²

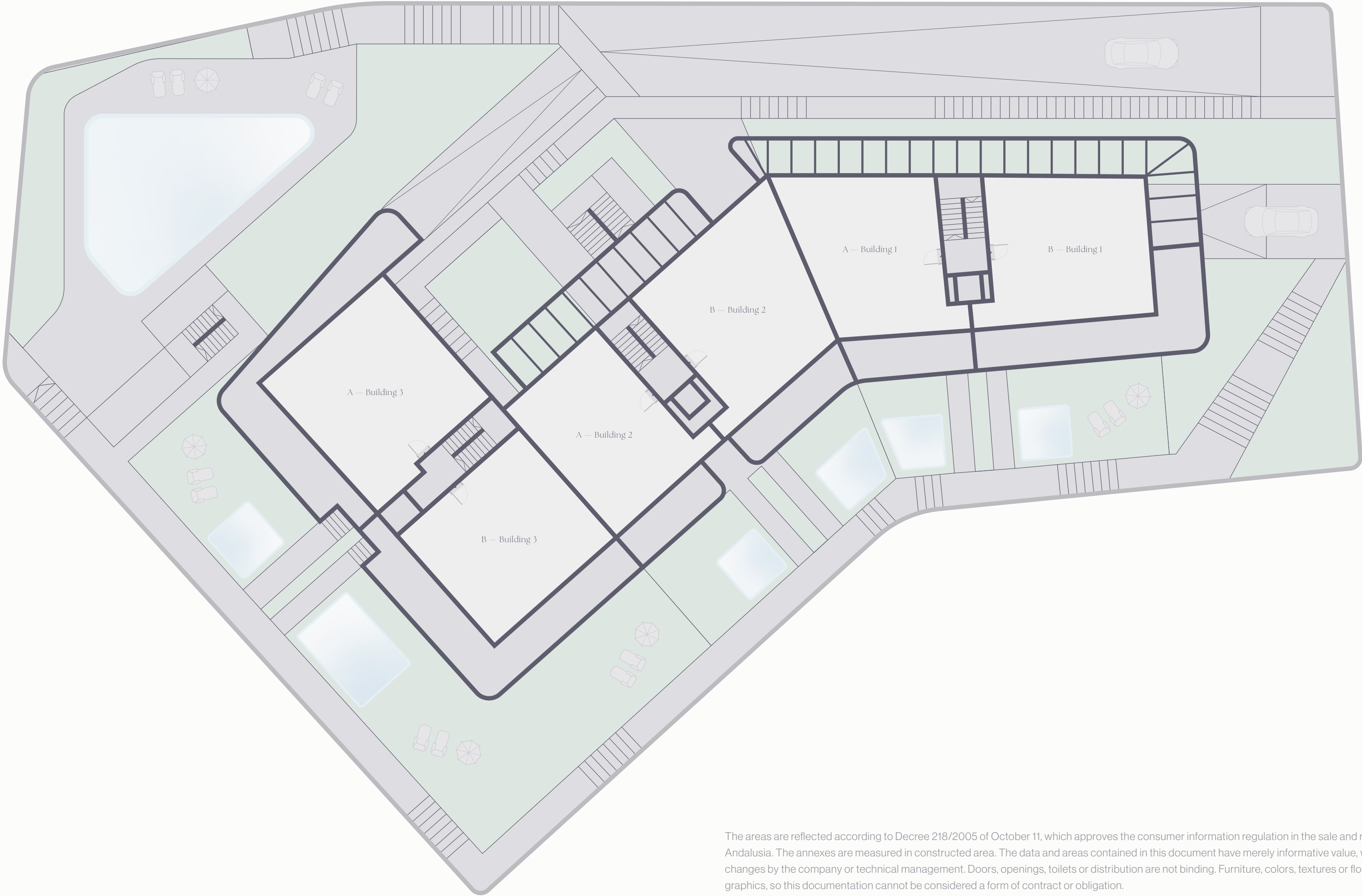
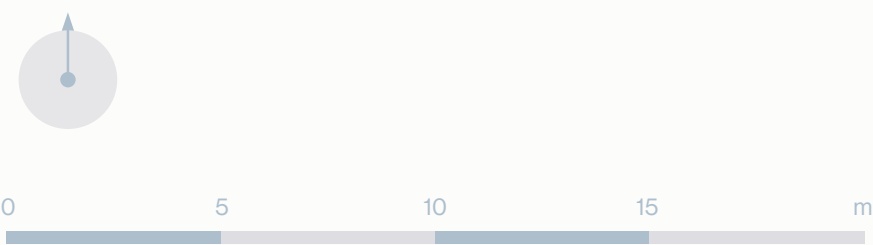

The areas are reflected according to Decree 218/2005 of October 11, which approves the consumer information regulation in the sale and rental of homes in Andalusia. The annexes are measured in constructed area. The data and areas contained in this document have merely informative value, which may be subject to changes by the company or technical management. Doors, openings, toilets or distribution are not binding. Furniture, colors, textures or flooring are only indicative graphics, so this documentation cannot be considered a form of contract or obligation.